



KU LEUVEN

**FACULTY OF
ENGINEERING SCIENCE**



European Network for Accreditation of
Engineering Education

1st ENAAEE Members' Forum I 2017

Date: 17th to 19th of October 2017

Location: University Leuven, KU Leuven

site: Arenberg Castle, Heverlee

Practical Information Members' Forum



Purpose and Audience

The Forum is primarily targeted at ENAAEE members and shall provide a platform for the exchange of experiences after 10 years of operation of ENAAEE and improve the inclusion of the expertise of those members who are not Accreditation Agencies, in particular Engineering Associations and Higher Education Associations and Networks. In addition, experts and representatives from organisations and projects dealing with HE Quality Assurance and external programme accreditation, from industry and Professional Institutions are invited.

Main topics:

- Recent developments and future challenges in HE Quality Assurance and its implications for programme accreditation in engineering education and for the EUR-ACE labels;
- Good practice in programme accreditation and possibilities for improvement, e.g. in learning outcomes assessment, synergies of external and internal quality assurance, extending the enhancement function of external accreditation and qualifying peers/accreditors accordingly;
- Improving the value and recognition of EUR-ACE labels nationally and internationally.

The central aim is to stimulate reflections on the experiences gained in programme accreditation and the delivery of EUR-ACE labels, to promote a dialog with academia and the professional world and to arrive at recommendations for activities of ENAAEE in the future. Experienced accreditors of the ENAAEE Member Agencies will take part. Respectively, the other member organisations are encouraged to delegate representatives from the educational and professional world familiar with programme accreditation and quality evaluation and management.

WIRELESS INTERNET

How to get wireless internet access on the campus?

KU Leuven has a growing number of wireless access points, offering access to the networks: campusroam and eduroam.

Campusroam is the collective name for the network at KU Leuven for visitors, available in public areas at KU Leuven, such as auditoriums, libraries, PC rooms and Alma restaurants.

Configuration info

- Select 'campusroam' in the list of WiFi networks + connect
- Username: provided username, **followed by @kuleuven.be**
- Password: the password that was provided with your KU Leuven-username
- For support with configuring wireless networks you can best contact the ICTS Servicedesk: 0032 16 32 28 00

Username and password will
be available at registration desk.

If you have **Eduroam** installed on your device, you can also log on there:

Configuration info

- Select 'eduroam' in the list of WiFi networks + connect
- Open your internet browser
- Browse to a page outside of the KU Leuven
- Use the username and password you have in your home university to log in

CONTACT

For remarks and questions to the organising committee please contact:
Günter Heitmann - guenter.heitmann@web.de

Logistics related questions
Elke Kalokerinos: +32 16 32 13 50 - elke.kalokerinos@eng.kuleuven.be

Taxi services
Taxi CORDONS Leuven: +32 16 222 000 - Mobile: +32 495 222 000

PROGRAMME AT A GLANCE

Time	Tuesday, 17th of October	Rooms (see p. 4 - A)
12:00-17:00	Arrival day, ENAEE Label Committee (LC) Meeting Buffet Lunch	200A 05.128

Time	Wednesday, 18th of October			Rooms (see p. 4 - B)
08:30-09:00	Registration			KAST 01.06 Kapel
09:00-09:30				
09:30-10:00	Official Opening of the Forum			KAST 01.07 Auditorium
10:00-10:30	Plenary Session 1: Good practice in EUR-ACE label programme accreditation			KAST 01.07 Auditorium
10:30-11:00				
11:00-11:25	Coffee Break			KAST 01.01 Prinsenzaal
11:30-12:00	Workshop 1: External programme accreditation: the benefits beyond the EUR-ACE label	Workshop 2: EUR-ACE programme outcomes in relation to national standards and requirements	Workshop 3: “Lean” accreditation procedures: adjustment to the purpose, use of synergies	Workshop 1: KAST 01.07 Workshop 2: KAST 01.29 Workshop 3: KAST 00.45
12:00-12:40				
12:45-13:00	Plenary: Presentation of workshop results, Wrap up by session moderator			KAST 01.07 Auditorium
13:00-13:15				
13:15-14:15	Light Lunch break			KAST 01.01 Prinsenzaal
14:30-15:00	Plenary session 2: EUR-ACE outcome standards and appropriate evidence of achievement			KAST 01.07 Auditorium
15:00-15:30				
15:30-15:55	Coffee Break			KAST 01.01 Prinsenzaal
16:00-16:30	Workshop 4: Assessment plans: Performance indicators for achieved programme aims and outcomes	Workshop 5: Achievement and assessment of complex learning outcomes – example: the CDIO approach	Workshop 6: Work-integrated and project-based learning and competence assessment	Workshop 4: KAST 01.07 Workshop 5: KAST 01.29 Workshop 6: KAST 00.45
16:30-17:10				
17:15-17:45	Plenary presentation of results, Wrap up by session moderator			KAST 01.07 Auditorium
19:30	Conference Dinner			Faculty Club (p.6 C)

Time	Thursday, 19th of October			Rooms (see p.4 - B)
09:00-09:30	Plenary session 3: Challenges and perspectives for future EUR-ACE label programme accreditation			KAST 01.07 Auditorium
09:30-10:00				
10:00-10:45				
10:45-11:10	Coffee Break			KAST 01.01 Prinsenzaal
11:15-11:30	Workshop 7: Transnational and cross-border EUR-ACE label programme accreditation	Workshop 8: Dealing with heterogeneous learning environments in programme accreditation	Workshop 9: How can the reputation and recognition of the EUR-ACE label & programme accreditation be increased at national and transnational level?	Workshop 7: KAST 01.07 Workshop 8: KAST 01.29 Workshop 9: KAST 00.73
11:30-12:00				
12:00-12:25				
12:30-13:00	Final plenary session			KAST 01.07 Auditorium
13:00-14:00				

VENUE MAP

PARKING

Free parking 'De Molen' near Arenberg Castle

P

Celestijnenlaan 131, 3001 Heverlee

Access code:
5205#

Don't forget the hashtag!



VENUE 17/10

Room 200A 05.128

A

Departement Computerwetenschappen
5th floor
Celestijnenlaan 200a
3001 Heverlee



VENUE 18 & 19/10

Arenberg castle

B

Kasteelpark Arenberg 1
3001 Heverlee



1. KAST 01.06 Kapel (1st floor)
2. KAST 01.07 Auditorium (1st floor)
3. KAST 01.01 Prinsenzaal (1st floor)
4. KAST 01.29 (1st floor)
5. KAST 00.45 - Eupoco (1st floor)
6. KAST 00.73 - Heraldique (ground floor)

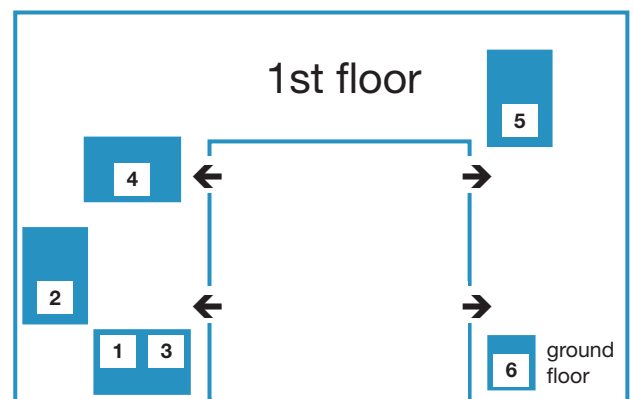

RESTO 18/10

Faculty Club

C

Groot Begijnhof 14
3000 Leuven
Access code parking: 2067

GPS: Tervuursevest 70, 3000 Leuven



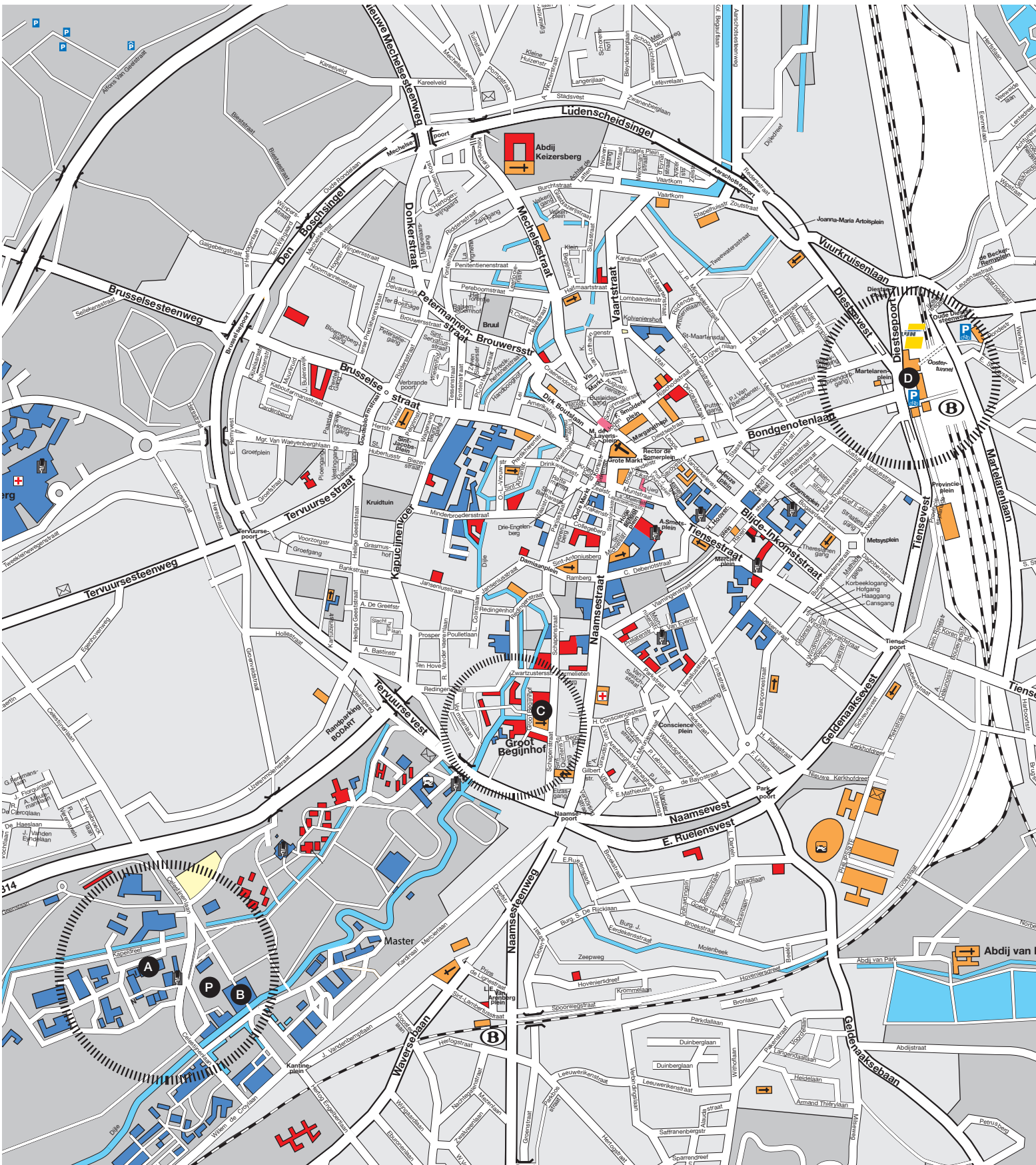

A

Department of Computer Science
Celestijnenlaan 200A, Heverlee

B

Arenberg Castle
Kasteelpark Arenberg 1, Heverlee

P

Parking

C

Faculty Club
Groot Begijnhof 14, Leuven

D

Station Leuven
Martelarenplein 16, 3000 Leuven

TRAVEL INFORMATION

FROM BRUSSELS AIRPORT (28 KM FROM LEUVEN)

- **From airport to Leuven by car:**
Leuven is located approximately a 20 minutes' drive from the Belgian National Airport of Zaventem.
- **From airport to Leuven by train:**
The airport has its own train station (Brussels National Airport), with direct trains to Leuven. The station is underneath the airport and is accessed via lifts and escalators in the arrivals hall.

More info: <http://www.belgianrail.be/en/stations-and-train/fast-airport-connections.aspx>

Timetable trains Brussels Airport - Leuven:

Brussels Airport	hh:21	hh:38
Leuven	hh:34	hh:51

FROM BRUSSELS SOUTH CHARLEROI AIRPORT (90 KM FROM LEUVEN)

Brussels Charleroi South airport is one hour' drive from Leuven. If you land here, you can take the bus to Charleroi railway station and take a train from there to Leuven.

Car hire: Several car hire companies also operate from Charleroi (Brussels South) Airport:
<http://www.charleroi-airport.com/en/at-the-airport/car-rental/europcar/index.html>

www.charleroi-airport.com

BY CAR

Leuven is located at the junction of two important motorways: the E40 and the E314. In the city the 'P' signposts will guide you to the different car parks.

Car parks in Leuven:
<http://visitleuven.be/en/by-car>

More info: <http://www.kuleuven.be/transportation/car.html>

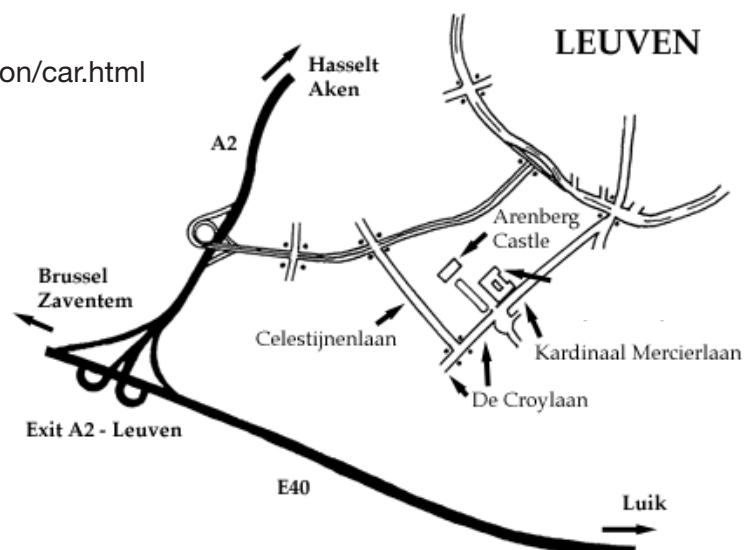

TRAVEL INFORMATION

FROM LEUVEN RAILWAY STATION

TO THE MEETING VENUE IN HEVERLEE



At Leuven station, you can take a **taxi** (this will take +/- 10 minutes) to the meeting venue.

You can also take **bus number 2 'Heverlee Campus'** in the direction 'Kantien/Campus'. The bus stops on the Kantineplein for the Arenberg Castle and Celestijnenlaan 300 for the LC meeting at the Department of Computer Science.

Timetable bus number 2:

<https://www.delijn.be/en/routeplanner>

TO THE FACULTY CLUB



At Leuven station, you can take a **taxi** (this will take 5-10 minutes) to the Faculty Club (2 km).

You can also take the **bus**:

o **bus number 1** Leuven-Heverlee:

⇒ 1 bus/h – 2 buses/h during peak hours

o **bus number 2** Kessel-Lo-Heverlee:

⇒ 8 buses/h

o **bus number 337** Brussel-Waver:

⇒ 1 bus/h – 2 buses/h during peak hours

o **bus number 600 'buitenringbus' or 601 'binnenringbus'**:

⇒ 6 buses/h

bus stops nearby:

o Sint-Kwintenskerk, Naamsestraat - distance to Faculty Club: 350m

o Sports Centre Ring Leuven - distance to Faculty Club: 250m

Timetables: www.delijn.be